



**Marine
Power
Products**

PARTS LIST

**CSG-850M/WSG-858M
(302-351 W C.I.D.)
MARINE**



GENERAL INFORMATION

This Ford Industrial Engine Parts Catalog has been prepared to assist you, the owner, in identifying the correct replacement parts for your Ford Industrial Engine.

The catalog is divided into major sections which correspond to specific areas of the engine, such as cylinder block, cylinder head, crankshaft, oil pump, water pump, etc. Each of these sections is made up of illustrations followed by text for identifying detail parts.

ILLUSTRATIONS

The illustrations show typical assemblies but may not in all cases show the shape or details of parts required. However, the purpose of the illustrations is to identify parts through visual and descriptive assistance. Illustrations are located at the beginning of each section or immediately adjacent to the applicable text. Parts are identified on each illustration by reference numbers. Find the reference number of the part desired and locate it in the parts list reference column. As you will note, only the year, part name description and quantity are shown. When ordering replacement parts for your engine it will be necessary to contact your local Ford Power Products distributor whose phone number can be found on the inside cover of this parts list.

PARTS INFORMATION

Each listing contains illustrations, reference number, the effective year range, part name including description, and the quantity required to assist in identifying the correct part.

SYMBOLS IN YEAR COLUMN

- 72 Parts used commencing with initial production of engines are indicated by only the year in which production commenced.
- 72/75 Parts used for a period of years and then discontinued are indicated in the year column by a commencing and finishing year.
- 75/ Parts still used in current production are indicated by the commencing year followed by a slant (/).

NOTE: The descriptions and specifications contained in this manual were in effect at the time the book was released for printing. Ford Motor Company reserves the right to discontinue models at any time, or change specifications or design, without notice and without incurring obligation.

CSG-850M and WSG 858M
302 CID and 351W CID
MARINE GASOLINE ENGINE



INDEX

ALTERNATOR	29
BEARINGS - CONNECTING ROD	6
BEARINGS - CRANKSHAFT MAIN	14
CAMSHAFT AND RELATED PARTS	10
CARBURETOR	32
CONNECTING ROD	6
CRANKSHAFT AND RELATED PARTS	14
CYLINDER ASSEMBLY	2
CYLINDER BLOCK AND PLUGS	2
CYLINDER HEAD	4
DISTRIBUTOR	40
FLYWHEEL AND RING GEAR	14
FRONT COVER - CYLINDER	2
IGNITION COIL	40
MANIFOLD - INTAKE	30
OIL FILTER	24
OIL LEVEL INDICATOR	24
OIL PAN	24
PISTON	6
PLATE - REAR ENGINE	14
PUMP - FUEL	30
PUMP - OIL	24
PUMP - WATER	28
SPARK PLUGS	40
STARTER	36
VALVES AND VALVE TRAIN PARTS	18
VOLTAGE REGULATOR	29

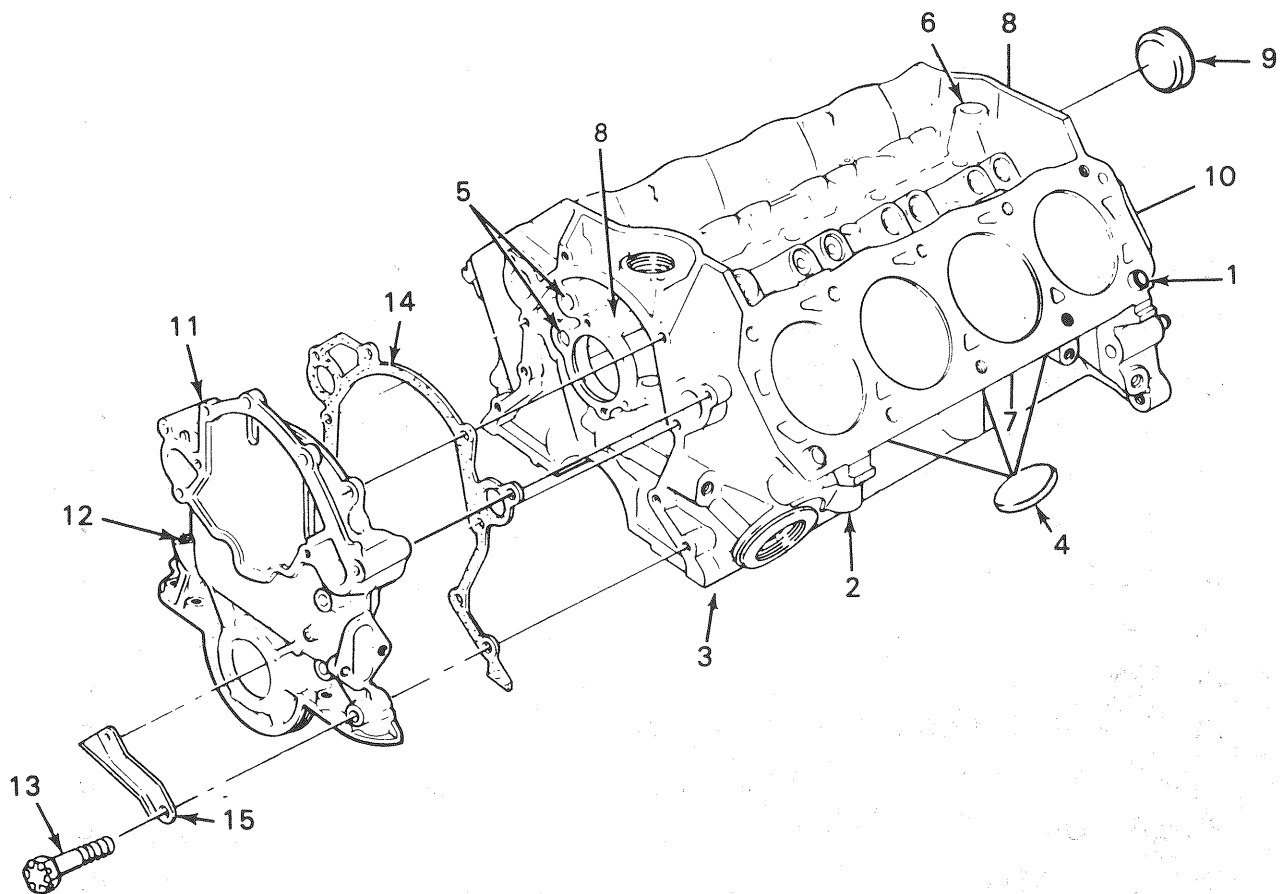

IE-1

CYLINDER BLOCK AND RELATED PARTS — TYPICAL

**CSG-850M and WSG 858M
302 CID and 351W CID
MARINE GASOLINE ENGINE**



REF. NO.	YEAR	DESCRIPTION	QUANTITY	
			302	351W
CYLINDER BLOCK AND RELATED PARTS				
DOWEL - CYLINDER HEAD TO BLOCK				
1	71/	All	4	4
CYLINDER ASSEMBLY				
INCLUDES CYLINDER BLOCK WITH ALL INTERNAL PARTS OF THE ENGINE. BUT DOES NOT INCLUDE CYLINDER HEADS, OIL PAN OR CYLINDER FRONT COVER.				
2	71/76	*2V - Low Output - Std. Rot.	1	
	71/76	*2V - Low Output - Rev. Rot.	1	
	77/	2V - Low Output - Std. Rot.	1	
	77	2V - Low Output - Rev. Rot.	1	
	71/76	*2V - Std. Rot.	1	
	71/76	*2V - Rev. Rot.	1	
	71/76	*4V - Std. Rot.	1	
	71/76	*4V - Rev. Rot.	1	
	77/	2V - High Output - Std. Rot.	1	
	77	2V - High Output - Rev. Rot.	1	
	77/	4V - Std. Rot.	1	
	77/	4V - Rev. Rot.	1	
	71/	Std. Rot. - On 76 And Prior Engines, Change Distributor Timing From 10° BTDC To 4° BTDC.		1
	71/	Rev. Rot. - On 76 And Prior Engines, Change Distributor Timing From 10° BTDC To 4° BTDC.		1
<i>*Change To Shorter Push Rod No. C80Z-6565-A</i>				
BLOCK ASSEMBLY - CYLINDER				
3	71/76	Change To Shorter Push Rod - No. C80Z-6565-A	1	
	77/	1	
	71/		1
4	71/	Plug - Clean Out Holes - 1 1/2 Cup - Brass.	6	6
5	71/	Plug - Oil Passage - 1/2 Cup	2	2
6	71/	Plug - Rear Hole in Block - 3/4 Cup	1	1
7	71/	Plug - Water Drain - 1/4 NPT - Brass.	2	2
8	71/	Plug - Oil Gallery - 1/4 NPT.	AR	AR
9	71/	Plug - Camshaft Rear Bearing	1	1
	71/	Plug - Camshaft Rear Bearing - .060 O/S.	AR	AR
10	71/	Dowel - Block To F/W Housing.	2	2
COVER ASSEMBLY - CYLINDER FRONT				
11	71/	1	1
12	71/	Plug - Oil Level Indicator Hole - 1/2 Cup.	AR	AR
13	71/	Bolt - Front Cover To Cylinder Block	2	2
GASKET - CYLINDER FRONT COVER				
14	71/	1	1
POINTER - ENGINE TIMING				
15	71/	1	1

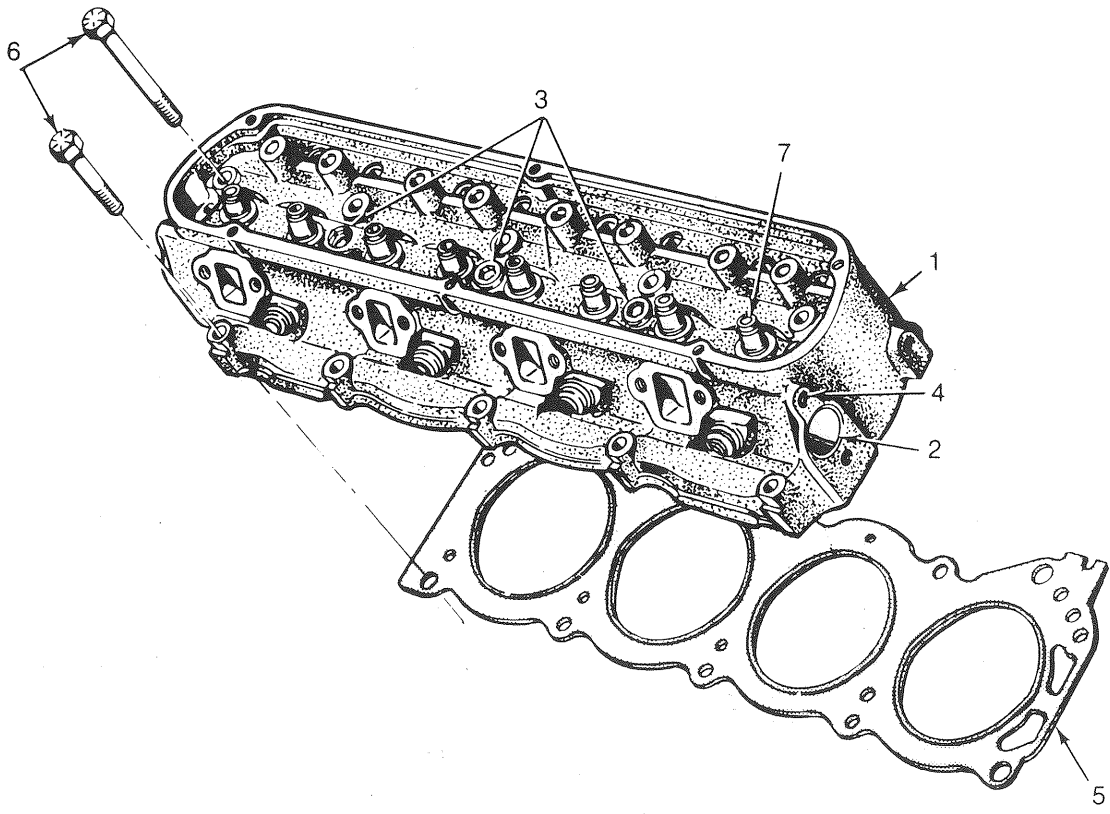

CYLINDER HEAD AND RELATED PARTS — TYPICAL

IE-2

**CSG-850M and WSG 858M
302 CID and 351W CID
MARINE GASOLINE ENGINE**



REF. NO.	YEAR	DESCRIPTION	QUANTITY	
			302	351W
CYLINDER HEAD AND RELATED PARTS				
HEAD ASSEMBLY - CYLINDER				
1	71/74	★Low Output - 18mm Spark Plugs	2	
	75/76	★Low Output - 14mm Spark Plugs	2	
	77/78	★Low Output - 14mm Spark Plugs	2	
	78/	Low Output - With Stamped Steel Rocker Arms	2	
	78/	Low Output - Complete - With Stamped Steel Rocker Arms	2	
	71/74	★Except Low Output - 18mm Spark Plugs	2	2
	71/74	Except Low Output - 18mm Spark Plug - Complete	2	2
	75/76	Except Low Output - 14mm Spark Plugs - Complete	2	
	77/78	Except Low Output	2	
	78/	Except Low Output - With Stamped Steel Rocker Arms	2	
	78/	Except Low Output - Complete - With S.S. Rocker Arm	2	
	75/76	14mm Spark Plugs - Complete		2
	77/78	★		2
	78/	With Stamped Steel Rocker Arms		2
	78/	Complete - With Stamped Steel Rocker Arms		2
2	71/	Plug - Core Holes - Brass Cup	4	4
3	71/	Plug - Core Holes - 3/4 NPT - Cast Iron	AR	6
4	75/	Insert - Plug T/E Hole - 5/8-11 OD 7/16-14 ID	4	4
<p>★Note: Change cylinder head clean out hole plugs from steel to brass 383445-S two per head and from steel to cast iron 370731-S three per head. Also on 302 engines built after 11/15/73 must use cylinder head bolts 383186-S and 383187-S.</p>				
GASKET - CYLINDER HEAD				
5	71/	2	
	71/		2
BOLTS - CYLINDER HEAD				
6	71/	Low Output - 7/16 - 14 x 2.32	10	
	71/	Low Output - 7/16 - 14 x 3.94	10	
	71/74	Except Low Output - 7/16 - 14 x 5.88 On Engines Built Prior To 11/15/73	10	
	71/74	Except Low Output - 7/16 - 14 x 2.26 On Engines Built Prior To 11/15/73	10	
	74/	Except Low Output Engines Built After 11/15/73	10	
	74/	Except Low Output Engines Built After 11/15/73	10	
	71/	1/2 - 13 x 2.50		10
	71/	1/2 - 13 x 4.00		10
BUSHING - VALVE GUIDE				
BUSHING MUST BE REAMED TO SIZE OF VALVE STEM PLUS CLEARANCE.				
7	71/	Intake and Exhaust .313 I.D. x 2.29 Long x .501 O.D.	AR	AR

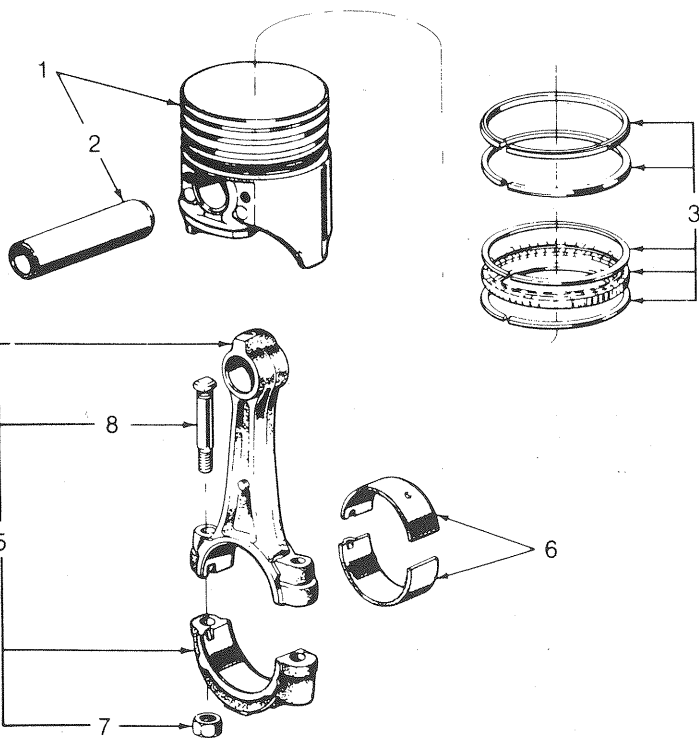

FIRING ORDER
Standard Rotation
1-3-7-2-6-5-4-8
Reverse Rotation
1-8-4-5-6-2-7-3

4

PISTON, CONNECTING ROD AND RELATED PARTS — TYPICAL

IE-3